

# Universal Joint Driveshaft XT Series-Heavy Duty

## Engineering Data [XT-Series]

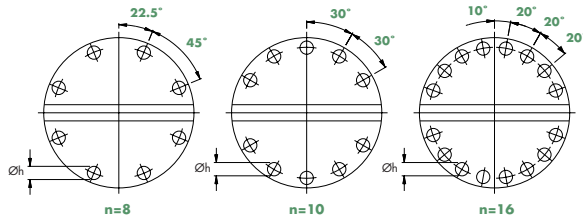
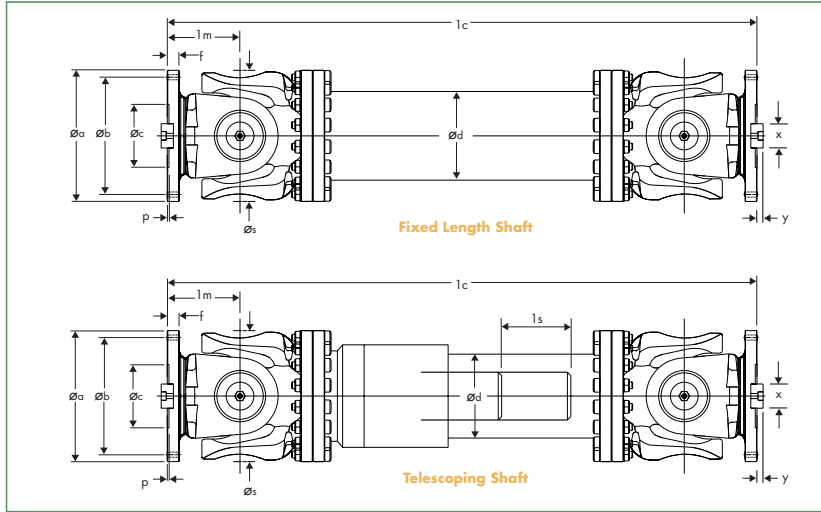

Note: Following designs & options available upon request, identified by letter "X" at the end of the size number:

- fixed
- short coupled
- long slip
- compact double flange type
- greater deflection angle
- oversized tube
- hole type yoke
- custom flange

- T<sub>p</sub>** peak torque
- T<sub>nrf</sub>** non-rev fatigue torque
- T<sub>rf</sub>** reverse fatigue torque
- angle** maximum deflection angle
- Ø<sub>a</sub>** flange diameter
- Ø<sub>b</sub>** bolt circle diameter
- Ø<sub>c</sub>** pilot diameter
- Ø<sub>d</sub>** tube outer diameter
- Ø<sub>s</sub>** swing diameter
- l<sub>s</sub>** slip length
- l<sub>m</sub>** flange - cross length
- n** bolt pattern
- Ø<sub>h</sub>** hole diameter
- f** flange thickness
- p** pilot depth
- x** width of key
- y** half thickness of key

DRIVESHAFT SIZE		XT 22-20	XT 25-25	XT 28-28	XT 31-31	XT 35-35	XT 39-39	XT 43-44	XT 48-49	XT 55-55	
Torque Ratings	T <sub>p</sub>	in.lbs	424,836	637,254	920,477	1,309,910	1,858,656	2,566,716	4,602,387	5,664,477	9,116,267
		kNm	48	72	104	148	210	290	520	640	1030
	T <sub>nrf</sub>	in.lbs	309,776	460,239	663,806	947,030	1,345,313	1,858,656	3,336,731	4,106,746	6,611,507
		kNm	35	52	75	107	152	210	377	464	747
T <sub>rf</sub>	in.lbs	212,418	318,627	460,239	654,955	929,328	1,283,358	2,301,194	2,832,238	4,558,134	
	kNm	24	36	52	74	105	145	260	320	515	
Standard Dimensions	Angle (degree)	15	15	15	15	15	15	15	15	15	
	l <sub>c</sub>	in	36.22	40.75	45.47	49.80	52.76	60.04	73.03	76.97	87.60
		mm	920	1035	1155	1265	1340	1525	1855	1955	2225
	Ø <sub>a</sub>	in	8.86	9.84	11.22	12.40	13.78	15.35	17.13	18.90	21.65
		mm	225	250	285	315	350	390	435	480	550
	Ø <sub>b</sub>	in	7.72	8.58	9.65	11.02	12.20	13.58	15.16	16.73	19.37
		mm	196	218	245	280	310	345	385	425	492
	Ø <sub>c</sub>	in	4.13	4.13	4.92	5.12	6.10	6.69	7.48	8.07	9.84
		mm	105	105	125	130	155	170	190	205	250
	Ø <sub>d</sub>	in	6.00	6.50	7.99	8.74	8.84	10.50	12.75	14.01	16.50
		mm	152.4	165.1	203.0	222.0	224.5	266.7	323.9	355.9	419.0
	Ø <sub>s</sub>	in	8.19	9.84	11.22	12.40	13.78	15.35	17.32	19.29	21.65
		mm	208	250	285	315	350	390	440	490	550
	l <sub>s</sub>	in	5.00	5.00	5.00	5.00	5.00	5.00	5.00	6.50	7.48
		mm	127	127	127	127	127	127	127	165	190
	l <sub>m</sub>	in	4.72	5.51	6.30	7.09	7.64	8.46	10.24	10.63	12.01
mm		120	140	160	180	194	215	260	270	305	
n		8	8	8	10	10	10	16	16	16	
Ø <sub>h</sub>	in	0.67	0.75	0.83	0.91	0.91	0.98	1.10	1.22	1.22	
	mm	17	19	21	23	23	25	28	31	31	
f	in	0.79	0.98	1.06	1.26	1.38	1.57	1.65	1.85	1.97	
	mm	20	25	27	32	35	40	42	47	50	
p	in	0.20	0.24	0.28	0.31	0.31	0.31	0.39	0.47	0.47	
	mm	5	6	7	8	8	8	10	12	12	
x	in	1.26	1.57	1.57	1.57	1.97	2.76	3.15	3.54	3.94	
	mm	32	40	40	40	50	70	80	90	100	
y	in	0.35	0.49	0.59	0.59	0.63	0.71	0.79	0.89	0.89	
	mm	9.0	12.5	15.0	15.0	16.0	18.0	20.0	22.5	22.5	

Part Number Designation: Example XT 22-20

XT = Xtek Torque Series      22 = Flange Diameter (Ø<sub>a</sub>)

20 = Tight Joint Swing (Ø<sub>s</sub>)



11451 Reading Road  
Cincinnati, Ohio 45241 USA

888.332.XTEK phone  
513.733.7820 fax

www.xtek.com



11451 Reading Road 888.332.XTEK phone  
Cincinnati, Ohio 45241 USA 513.733.7820 fax

## Engineering Data [XT-Series]

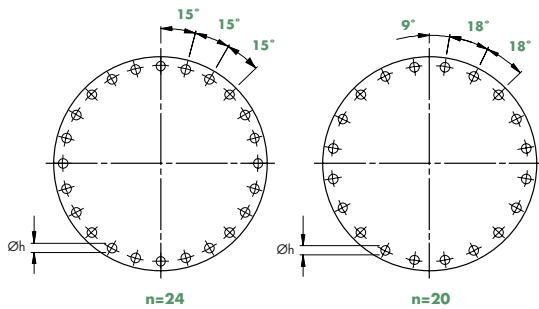
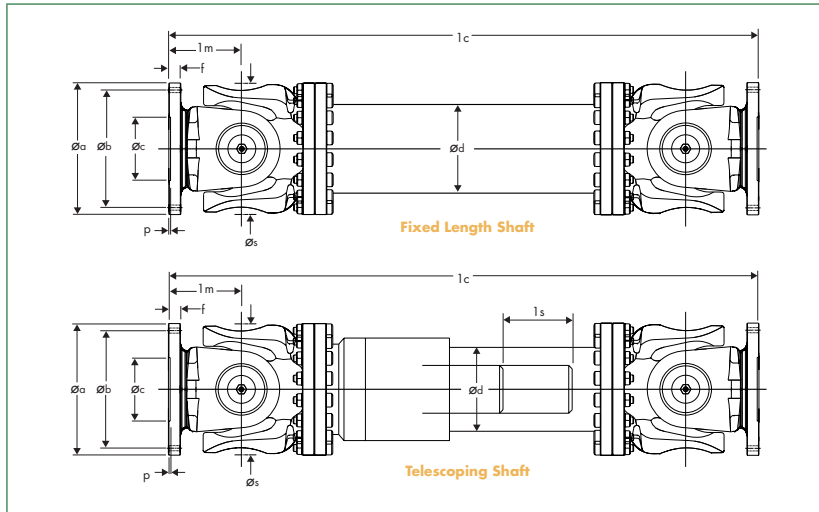

**Tp**  peak torque  
 **Tnrf**  non-rev fatigue torque  
 **Trf**  reverse fatigue torque  
  
 **angle**  maximum deflection angle  
 **Øa**  flange diameter  
 **Øb**  bolt circle diameter  
 **Øc**  pilot diameter  
 **Ød**  tube outer diameter  
 **Øs**  swing diameter  
 **ls**  slip length  
 **lm**  flange - cross length  
 **n**  bolt pattern  
 **Øh**  hole diameter  
 **f**  flange thickness

Note: Following designs & options available upon request, identified by letter "X" at the end of the size number:

- fixed
- long slip
- flange with hirth serration
- flange with face key
- flange with integral face pad

## Universal Joint Driveshaft XT Series-Heavy Duty

DRIVESHAFT SIZE		XT 60-60	XT 62-62	XT 64-64	XT 66-66	XT 68-68	XT 70-70	XT 76-76	XT 78-78	XT 80-80	
Torque Ratings	Tp	in.lbs	10,620,894	11,063,431	13,453,132	13,895,670	14,249,699	14,957,759	23,454,474	24,339,549	25,136,116
		kNm	1200	1250	1520	1570	1610	1690	2650	2750	2840
	Tnrf	in.lbs	9,558,805	9,912,834	12,125,521	12,479,550	12,833,580	13,453,132	21,064,773	21,949,848	22,569,400
		kNm	1080	1120	1370	1410	1450	1520	2380	2480	2550
Trf	in.lbs	6,195,522	6,461,044	7,788,656	8,054,178	8,319,700	8,673,730	13,630,147	14,161,192	14,603,729	
	kNm	700	730	880	910	940	980	1540	1600	1650	
Standard Dimensions	Angle (degree)		15	15	15	15	15	15	15	15	15
		lc	in	107.28	108.27	112.20	118.11	120.08	122.05	135.83	137.80
		mm	2725	2750	2850	3000	3050	3100	3450	3500	3550
	Øa	in	23.62	24.41	25.20	25.98	26.77	27.56	29.92	30.71	31.50
		mm	600	620	640	660	680	700	760	780	800
	Øb	in	21.85	22.64	23.43	24.21	25.00	25.79	27.76	28.54	29.33
		mm	555	575	595	615	635	655	705	725	745
	Øc	in	18.90	19.69	20.47	20.87	21.65	22.44	24.41	25.20	25.98
		mm	480	500	520	530	550	570	620	640	660
	Ød	in	20.00	20.00	20.00	20.00	20.00	20.00	25.98	25.98	25.98
		mm	508	508	508	508	508	508	660	660	660
	Øs	in	23.62	24.41	25.20	25.98	26.77	27.56	29.92	30.71	31.50
mm		600	620	640	660	680	700	760	780	800	
ls	in	9.84	9.84	9.84	9.84	9.84	9.84	9.84	9.84	9.84	
	mm	250	250	250	250	250	250	250	250	250	
lm	in	13.39	13.39	14.17	14.57	14.57	14.57	16.54	16.54	16.54	
	mm	340	340	360	370	370	370	420	420	420	
n		20	20	20	24	24	24	24	24	24	
	Øh	in	0.98	0.98	0.98	0.98	0.98	0.98	1.22	1.22	1.22
	mm	25	25	25	25	25	25	31	31	31	
f	in	2.95	2.95	3.15	3.35	3.35	3.54	3.74	3.74	3.94	
	mm	75	75	80	85	85	90	95	95	100	

Part Number Designation: Example XT 22-20

XT = Xtek Torque Series 22 = Flange Diameter (Øa)

20 = Tight Joint Swing (Øs)